

***Prism Glassworks  
Round “H”  
Channels***

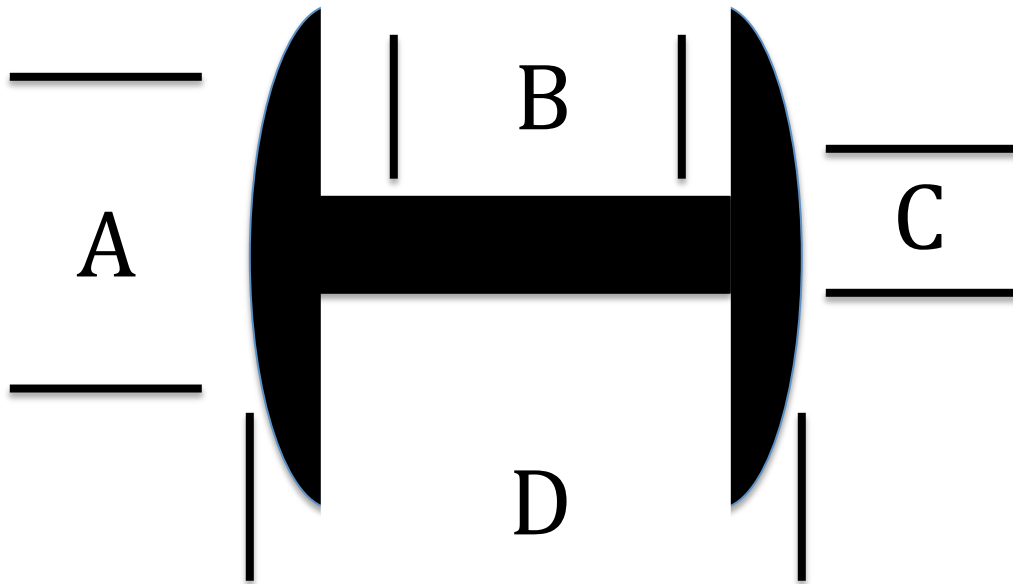

<b>Profile</b>	<b>Die #</b>	<b>A</b>	<b>B</b>	<b>C</b>	<b>D</b>
1/8 RH	90	.125	.176	.034	.263
5/32 RH	24	.155	.190	.035	.250
5/32 RH	P-2	.155	.190	.045	.330
5/32 RH	5590	.156	.156	.032	.250
3/16 RH	13	.210	.174	.028	.284
3/16 RH	14	.190	.175	.055	.315
3/16 RH	15	.180	.150	.032	.250
3/16 RH	16	.200	.200	.045	.310
3/16 RH	17	.190	.175	.030	.275
3/16 RH	68	.210	.190	.037	.310
7/32 RH Low Heart	20	.218	.150	.035	.270
7/32 RH BCL	21	.184	.161	.046	.268
7/32 RH HHH	23	.184	.214	.046	.322
7/32 RH HHH	22	.184	.176	.046	.283
1/4 RH	70	.250	.187	.040	.317
1/4 RH	222	.252	.185	.031	.304
1/4 RHBCL	71	.236	.176	.046	.212
1/4 RH	72	.250	.200	.046	.290
1/4 RH	7	.250	.270	.035	.400
1/4 RH HH	74	.245	.220	.032	.345
3/8 RH	50	.375	.176	.046	.306
3/8 Colonial	100	.310	.200	.050	.400
1/2 RH	3	.500	.530	.62	.713
1/2 RH	4	.500	.176	.046	.312
3/4 RH	2	.750	.530	.100	.713